

## **Notice of Proposal**

### **THE FLINTSHIRE COUNTY COUNCIL**

#### **PRINCE OF WALES AVENUE, PARK AVENUE, ST CATHERINES CLOSE AND ALLT GOCH, FLINT**

#### **PROPOSED PROHIBITION OF WAITING AND WAITING AT ANY TIME RESTRICTIONS**

Flintshire County Council propose to make an Order in exercise of its powers under the Road Traffic Regulation Act 1984, the Traffic Management Act 2004, Part IV of Schedule 9 and all other enabling powers, the effect of which will be to amend The Flintshire County Council (Prohibition and Restriction of Waiting and Loading and Parking Places) (Civil Enforcement and Consolidation) Order 2013, so as to introduce:-

1. 'No Waiting At Any Time' restrictions:-
  - a. At various locations on both sides of Prince of Wales Avenue, Flint
  - b. At various locations on both sides of Allt Goch, Flint
  - c. At the junction of Prince of Wales Avenue with Park Avenue, Flint
  - d. At the junction of Allt Goch with St Catherines Close, Flint
2. 'No Waiting Monday – Friday 8.30am – 9.30am and 2.30pm – 4.00pm' restrictions:
  - a. At various locations on both sides of Allt Goch, Flint
3. 'No Waiting Monday – Friday 8.00am – 4.30pm' restrictions:
  - a. At the School gate on the North East side of Prince of Wales Avenue, Flint.

In all other respects the present provisions of the 'The Flintshire County Council (Prohibition and Restriction of Waiting and Loading and Parking Places) (Civil Enforcement and Consolidation) Order 2013' will remain in force.

A copy of the Notice, the proposed Order, plans showing the roads affected by the proposal and a statement of the Council's reasons for proposing to make the Order, may be inspected during normal opening hours at Flint Connects Centre Church Street, Flint, CH6 5BD. The documents will also be available to viewed on our website at [www.Flintshire.gov.uk](http://www.Flintshire.gov.uk) > Resident > Roads, Streets and Travel > Traffic Regulation Orders or you can request a copy of the documents by emailing [Streetscene@flintshire.gov.uk](mailto:Streetscene@flintshire.gov.uk) or by calling 01352701234.

Objections to the proposed Order, together with the grounds on which they are made, should be sent in writing to the undersigned by Friday 9<sup>th</sup> December 2022 quoting reference SS/TRO/NW/54

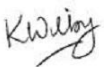

---

Katie Wilby,  
Chief Officer (Streetscene and Transportation), County Hall, Mold,  
Flintshire. CH7 6NR.  
Friday 18<sup>th</sup> November 2022

---

**THE FLINTSHIRE COUNTY COUNCIL**  
**PRINCE OF WALES AVENUE, PARK AVENUE, ST CATHERINES**  
**CLOSE AND ALLT GOCH, FLINT**  
**(PROHIBITION AND RESTRICTION OF WAITING**  
**AND LOADING AND PARKING PLACES)**  
**(CIVIL ENFORCEMENT AND CONSOLIDATION) (AMENDMENT**  
**NO. 54) ORDER 202-**

---

**Katie Wilby,**  
**Chief Officer (Streetscene & Transportation),**  
**County Hall,**  
**Mold,**  
**Flintshire,**  
**CH7 6NF**

**THE FLINTSHIRE COUNTY COUNCIL**

**PRINCE OF WALES AVENUE, PARK AVENUE, ST CATHERINES CLOSE AND ALLT  
GOCH, FLINT**

**(PROHIBITION AND RESTRICTION OF WAITING  
AND LOADING AND PARKING PLACES)**

**(CIVIL ENFORCEMENT AND CONSOLIDATION) (AMENDMENT NO.54) ORDER 202-**

Flintshire County Council in exercise of its powers under sections 1 (1), 2 (1)(2), 4 (2)(3) and Part IV of Schedule 9 of the Road Traffic Regulation Act 1984 (“the Act of 1984”) as amended, the Traffic Management Act 2004 (“the 2004 Act”) and of all other enabling powers and after consultation with the Chief Officer of Police in accordance with Part III of Schedule 9 to the Act of 1984, hereby makes the following Order:-

**SECTION 1 – PRELIMINARY**

**Citation and commencement**

1. This Order shall come into operation on the XX<sup>th</sup> XXX 202- and may be cited as The Flintshire County Council, PRINCE OF WALES AVENUE, PARK AVENUE, ST CATHERINES CLOSE AND ALLT GOCH, FLINT (Prohibition and Restriction of Waiting and Loading and Parking Places) (Civil Enforcement and Consolidation) (Amendment No. 54) Order 202-
2. With effect from the date set out in Article 1 above, Map Schedule AL59 Sheet Revision No: 5 replaces Map Schedule AL59 Sheet Revision 4 and Map Schedule AL60, Sheet Revision No: 3, replaces Map Schedules AL60 Sheet Revision No: 2 and all other map schedules together with the before mentioned map schedules and plans referred to in the Schedules to this Order are incorporated into The Flintshire County Council (Prohibition and Restriction of Waiting and Loading and Parking Places) (Civil Enforcement and Consolidation) Order 2013.
3. The interpretation Act 1978 shall apply for the interpretation on this Order as it applies for the interpretation of an Act of Parliament
4. In this Order, except where otherwise stated, any reference to a numbered Article or Schedule is a reference to the Article or Schedule bearing that number and any reference to a plan is reference to a plan incorporated in to this order.

**SCHEDULE 1**  
**No Waiting At Any Time**  
**Connah's Quay**

Road Name	Map Schedule	Sheet Revision
Prince of Wales Avenue	AL59	5 (which revokes revision Sheet 4 from the 2013 Order
Park Avenue	AL59	5 (which revokes revision Sheet 4 from the 2013 Order
Allt Goch	AL59	5 (which revokes revision Sheet 4 from the 2013 Order
	AL60	3 (which revokes revision Sheet 2 from the 2013 Order

THE COMMON SEAL of )  
 FLINTSHIRE COUNTY COUNCIL )  
 was hereunto affixed )  
 this xx<sup>th</sup> day of xxxx 202- )  
 in the presence of:- )

**CHAIRMAN**

**LEGAL SERVICES MANAGER**

**CHIEF OFFICER (GOVERNANCE)**

**PRINCE OF WALES AVENUE, PARK AVENUE, ST CATHERINES CLOSE AND  
ALLT OCH, FLINT  
PROPOSED PROHIBITION OF WAITING**

**Statement of Reasons for Proposing to Make the Order**

Flintshire County Council propose to introduce No Waiting at Any Time (double yellow lines) and Limited Waiting restrictions (single yellow line), in the roads as listed above.

The No Waiting At Any Time restrictions are intended to address indiscriminate parking, maintain visibility and to ensure that the junctions are not obstructed by parked vehicles.

Parking at junctions, regardless of the presence of yellow lines, is an offence and the restrictions provide a visual deterrent to reinforce this message. At present, should vehicles be parked within 10 metres of a junction, an act of criminality may be committed and would therefore be subject to enforcement action by North Wales Police. Furthermore the Highway Code states that vehicles should not park near or on a junction as they may cause obstruction and compromise safety for all road users.

The Introduction of the Limited Waiting restrictions, will improve pedestrian safety through the removal of parked vehicles at key locations, whilst reducing congestion and improving traffic flow around the School.

In the interests of road safety, the proposals are necessary to avoid danger to people or other traffic using the road, or preventing danger arising.

**The proposals are detailed in the Public Notice and in the proposed Order**

Dated this 18th day of November 2022

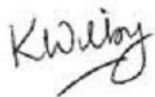

---

Katie Wilby,

Chief Officer (Streetscene & Transportation),  
County Hall,  
Mold,  
Flintshire.  
CH7 6NF

**FLINTSHIRE COUNTY COUNCIL  
THE ROAD TRAFFIC REGULATION ACT 1984**

**Notice of Proposal to Implement SCHOOL KEEP CLEAR Carriageway Markings at Ysgol  
Gwynedd, Flint**

**NOTICE** is hereby given that the Flintshire County Council in exercise of its powers under The Road Traffic Regulation Act 1984, propose to introduce a 'School Keep Clear' restriction, of up to 43 metres in length on Allt Goch, Flint, on the south-west of the carriageway at the rear entrance to Ysgol Gwynedd. Vehicles would be prohibited from stopping on the yellow zig-zag markings indicating the restriction between the hours of 8 a.m. and 5 p.m. on Mondays to Fridays inclusive.

**Reason for Proposal:** Complaints have been received about obstructive parking particularly at school peak times in the area around the rear entrance to the Ysgol Gwynedd. The Council therefore proposes to introduce a No stopping on School Keep Clear marking restriction. The purpose of providing School Keep Clear markings is to keep the space outside of schools free from parked vehicles so that children can be seen more easily when crossing the road.

A copy of the Notice, plans showing the road affected by the proposal and a statement of the Council's reasons for proposing the restriction, may be inspected during normal opening hours at Flint Connects Centre Church Street, Flint, CH6 5BD. The documents will also be available to be viewed on our website at [www.Flintshire.gov.uk](http://www.Flintshire.gov.uk) > Resident > Roads, Streets and Travel > Traffic Regulation Orders or you can request a copy of the documents by emailing [Streetscene@flintshire.gov.uk](mailto:Streetscene@flintshire.gov.uk) or by calling 01352701234.

Any objections to the above proposal, together with the grounds on which they are made, should be sent to the undersigned at the address given below (quoting reference TC/CP/SKCF/2022) by Friday 09<sup>th</sup> December 2022.

Dated this 18<sup>th</sup> day of November 2022

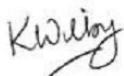

---

Katie Wilby,  
Chief Officer (Streetscene and Transportation),  
County Hall,  
Mold,  
Flintshire.  
CH7 6NR

AREA CODE:AL59  
COD ARDAL:AL59



Sheet Revision No: 5  
Rhif Adolgiad Y Ddalen: 5  
Sheet active from: XX XXX 20XX  
Dalen yn weithredol o: XX XXX 20X

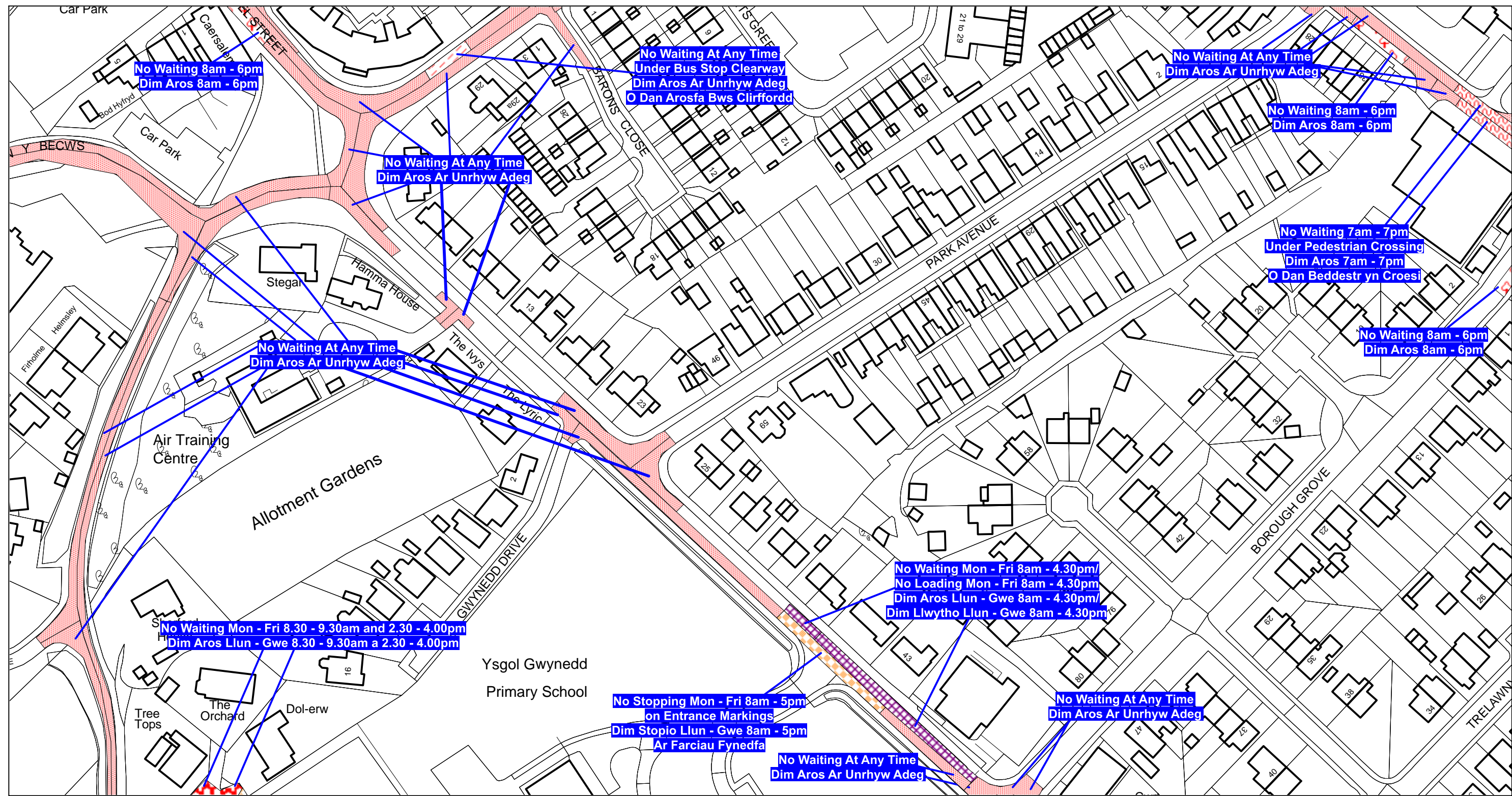



AREA CODE:AL60  
COD ARDAL:AL60



Sheet Revision No: 3  
Rhif Adolgiad Y Ddalen: 3  
Sheet active from: XX XXX 20XX  
Dalen yn weithredol o: XX XXX 20X

